

# Pitts Baptist Church Facilities Use Request Form

140 Pitts School Rd, NW, Concord, NC 28027 ~ 704-786-1953 ~ Fax: 704-782-3096



Church facilities should be used to the fullest extent by providing opportunities for worship, fellowship, education, service, and evangelism. The use of church facilities is only available to church members in accordance with our Building & Grounds Policy. Please remember that this is only a **REQUEST FORM**. Once completed, this form will then be reviewed by the church staff and Pastor to determine if it is in line with the purpose of Pitts Baptist Church. You will be notified of the status of your request following the next available staff meeting (held on Tuesday mornings). Once approved, your event will be placed on the church calendar. If changes are made to this request after approval (i.e. additional time, space, audio/visual assistance), a new request form will need to be submitted. **Please understand that all regularly-scheduled church events take precedence over any small group event. This includes set-up time for the event. If the date or any other details of your event changes, it is your responsibility to notify the church office in a timely manner. Requests for the month of December will not be approved until October, following the Staff Planning Meeting.**

Today's Date: \_\_\_\_\_ Event Date: \_\_\_\_ / \_\_\_\_ / \_\_\_\_ (M/D/Y)

Name: \_\_\_\_\_ Email: \_\_\_\_\_

Phone: \_\_\_\_\_ (home) \_\_\_\_\_

(mobile)

Type of event: (please give complete description) \_\_\_\_\_

Group/Sunday School Class: \_\_\_\_\_

**AUDIO/VISUAL** - Are you requesting audio/visual assistance? \_\_\_\_\_ yes \_\_\_\_\_ no

*(Use of any audio/visual equipment requires a Pitts Baptist Church sound technician, pending their availability. Additional fees will apply for private events (\$50 minimum).*

**Check one:** \_\_\_\_\_ This event is open to the entire church. \_\_\_\_\_ This is a private event.

**Event Start Time:** \_\_\_\_\_ **Event End Time:** \_\_\_\_\_ **Number expected:** \_\_\_\_\_

If you need time to set up **before the event**, please indicate:

**Setup Date:** \_\_\_\_\_ **Setup Time:** (time building will be entered): \_\_\_\_\_

**Cleanup Time** (time room will be vacated): \_\_\_\_\_ *(Please Note: For weekend events, the CORE must be vacated by 9:00 pm)*

**Setup, teardown, and cleaning will be the responsibility of the person making the reservation.**

## Use of Property by a Member of Pitts Baptist Church

Personal family events: birthday parties, anniversaries, family reunions, and similar events will require a Building Use Fee. *(Members are responsible for removal of trash and resetting the room as found.)*

### **Building Use Fees for Personal Events\* (PER DAY):**

CORE Large Multi-purpose Room (gym)	\$100
CORE Activity Room	\$ 50
CORE Café	\$ 50
Small Fellowship Hall	\$ 50
Chapel	\$ 40

**\*All fees must be received in the church office one week prior to the event. Use of multiple rooms will require a multiple fee (example: use of Café and Activity Room - \$150)**

Continued on back

Please check all buildings/rooms that will be used for this event (check each location you will be using):

- Sanctuary
- Chapel
- Education Building C Classroom
- Education Building B Classroom
- Small Fellowship Hall
- Small Fellowship Hall Kitchen
- CORE Gym
- CORE Café
- CORE Activity Room
- CORE PEAK
- CORE Classroom
- CORE Kitchen
- Other \_\_\_\_\_

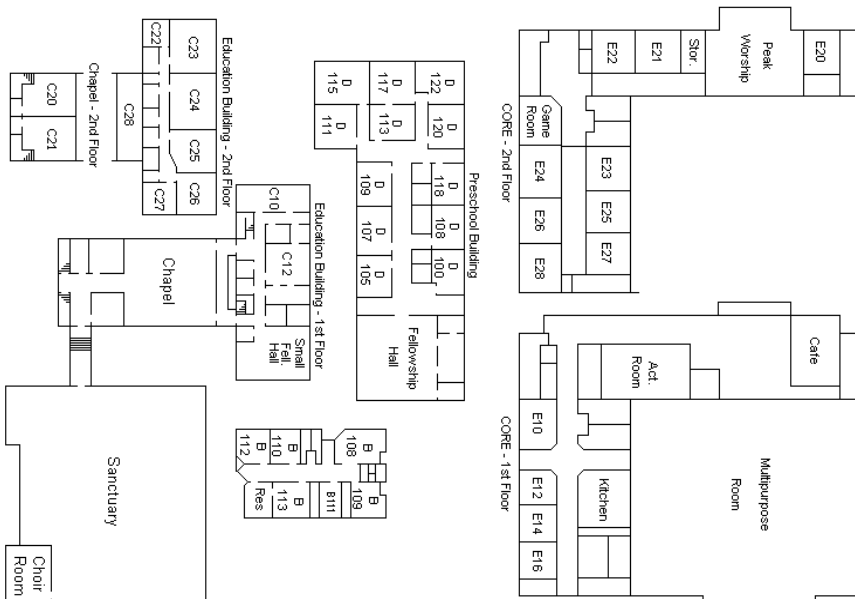

\* Large Fellowship Hall not available for use by groups or individuals due to strict sanitation guidelines involving children.

→ When reserving the CORE, children are to be supervised by an adult at all times and are not permitted to be on the gym stage.

Copies of the *Pitts Baptist Church Building and Grounds Use Policy* are available in the church office.

Weddings must refer to the *Wedding Policy* for detailed information and fees.

**Tablecloths:** Church tablecloths are reserved for church ministry functions only. Tablecloths used for weddings or other family events will need to be rented or purchased by the individual.

**KEYS:** Church keys for the event must be secured from the church office by 5:00 pm on the business day preceding the event. Following the event, the key must be returned to the drop box located outside of the Education B Building or returned to the church office. Do NOT duplicate keys.

\_\_\_\_\_  
(Initial here)

I have read this form in its entirety and understand that it is my responsibility to return the room to the same setup that was in the room before use. All trash accumulated during my event will be taken to the dumpster before I leave. I understand that changes to the details presented on this form will require that the request be resubmitted for approval.

Signed: \_\_\_\_\_ Date: \_\_\_\_\_

**OFFICE USE ONLY**

Date request approved: \_\_\_\_/\_\_\_\_/\_\_\_\_

Date notified: \_\_\_\_/\_\_\_\_/\_\_\_\_

Key Issued # \_\_\_\_\_

Date issued: \_\_\_\_/\_\_\_\_/\_\_\_\_

Date returned: \_\_\_\_/\_\_\_\_/\_\_\_\_

Building Use Fee: \$ \_\_\_\_\_

Audio/Visual Fee: \$ \_\_\_\_\_

Fees due on: \_\_\_\_/\_\_\_\_/\_\_\_\_

Fees received on: \_\_\_\_/\_\_\_\_/\_\_\_\_